

Pistol Laser Trainer

LT-PRO

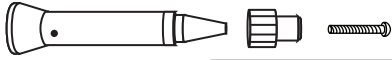

THE BATTERIES ARE ALREADY INSTALLED, YOU MUST REMOVE A PIECE OF PLASTIC INSULATOR BEFORE OPERATION

Installation:

- 1 **UNLOAD YOUR FIREARM!**
- 2 Remove plastic insulator from batteries.
- 3 Insert screw through adapter and thread into taper of trainer.
- 4 Tighten or loosen screw for caliber fit.
- 5 Gently press the trainer into the muzzle of the pistol.
- 6 Ready your pistol and pull trigger to fire red laser dot. (LaserLyte recommends the use of snap caps.)
- 7 When removing from your pistol, pull straight out! Do not twist! Ensure all parts are out of barrel.
- 8 When not in use remove batteries and insert insulator for storage.

3

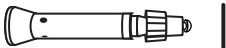

4



5

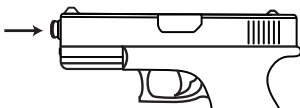
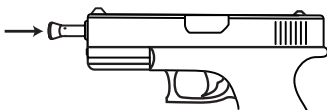
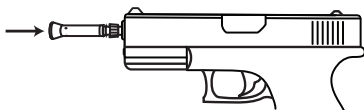

6

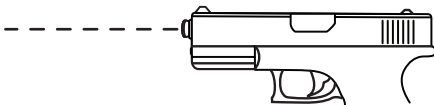

7 **Correct removal**

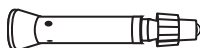

Batteries: (3) 377

- 1 Unscrew Battery cap
- 2 Remove batteries.
- 3 Install new batteries.
- 4 Tighten battery cap

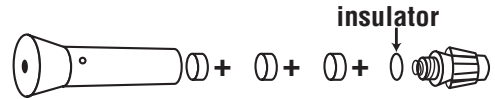

Training with the LT-PRO will improve:

- Trigger Control
- Unsighted Fire / Point and Shoot
- Shooting from the Holster
- Precision Shooting
- Unorthodox Shooting Positions

WARRANTY:
One Year Limited
Warranty.



A Division of P&L Industries
101 Airpark Road - Cottonwood, AZ 86326
Phone 928-649-3201 - Fax 928-649-3970
www.LaserLyte.com